

ELKAY® SPECIFICATIONS

Lustertone® Single Bowl Sink Models LR, LRQ, LRS and LRSQ Series

GENERAL

Highest quality sink seamlessly formed of #18 gauge, type 304 (18-8) nickel bearing stainless steel. Self-rimming.

DESIGN FEATURES

LR(Q) Bowl Depth: 8" (LR(Q)2521), 7-1/2" (LR(Q)1919), 7-5/8" (all others).

Coved Corners: 1-3/4" vertical and horizontal radius.

Bowl and Faucet Deck Recess: 3/16" below outside edge of sink.

Finish: Exposed surfaces are hand blended to a lustrous high-lighted satin finish.

Underside: Fully undercoated to dampen sound and prevent condensation. LR(Q)2521 is fully protected by heavy duty Sound Guard® undercoating.

OTHER

Drain Opening: 3-1/2".

NOTE: Unless otherwise specified, models with one, two, three or OS4 faucet hole option are furnished with 3 faucet holes as shown; models with choice of one, two, three, four or five faucet hole option are furnished with 4 faucet holes standard.

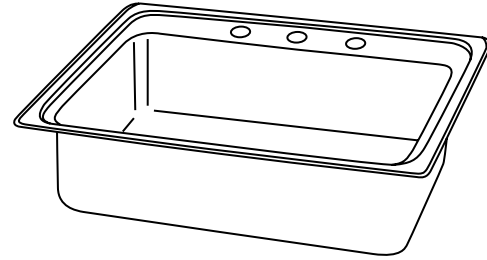

Model LR(Q)22193

SINK DIMENSIONS (INCHES)*

U-Channel Model Number	Quick-Clip® Model Number	Overall		Inside Bowl			Cutout in Countertop (1 1/2" Radius Corners)		No. of 1 1/2" Dia. Faucet Holes 4" Center	Minimum Cabinet Size	Ship. Wt. Lbs.
		L	W	L	W	D	L	W			
		A	B	C	D	E	L	W			
LR1316	LRQ1316	13	16	10	10	7 ⁵ / ₈	12 ³ / ₈	15 ³ / ₈	1, 2, MR2 or 3	18	9 ¹ / ₂
LR1517	LRQ1517	15	17 ¹ / ₂	12	12	7 ⁵ / ₈	14 ³ / ₈	16 ⁷ / ₈	1, 2, MR2 or 3	18	10
LR1522	LRQ1522	15	22	11 ¹ / ₂	16	7 ⁵ / ₈	14 ³ / ₈	21 ³ / ₈	1, 2, MR2 or 3	18	12
LR1716	LRQ1716	17	16	14	10	7 ⁵ / ₈	16 ³ / ₈	15 ³ / ₈	1, 2, MR2, 3 or OS4	21	12
LR1720	LRQ1720	17	20	14	14	7 ⁵ / ₈	16 ³ / ₈	19 ³ / ₈	1, 2, MR2, 3 or OS4	21	12
LR1722	LRQ1722	17	22	13 ¹ / ₂	16	7 ⁵ / ₈	16 ³ / ₈	21 ³ / ₈	1, 2, MR2, 3 or OS4	21	13
LR1918	LRQ1918	19	18	16	11 ¹ / ₂	7 ⁵ / ₈	18 ³ / ₈	17 ³ / ₈	1, 2, MR2, 3 or OS4	24	13
LR1919	LRQ1919	19 ¹ / ₂	19	16	13 ¹ / ₂	7 ¹ / ₂	18 ⁷ / ₈	18 ³ / ₈	1, 2, MR2, 3 or OS4	24	13
LR2022	LRQ2022	19 ¹ / ₂	22	16	16	7 ⁵ / ₈	18 ⁷ / ₈	21 ³ / ₈	1, 2, MR2, 3 or OS4	24	14 ¹ / ₂
LR2219	LRQ2219	22	19 ¹ / ₂	18	14	7 ⁵ / ₈	21 ³ / ₈	18 ⁷ / ₈	1, 2, MR2, 3, 4 or 5	27	13
LR2222	LRQ2222	22	22	19	16	7 ⁵ / ₈	21 ³ / ₈	21 ³ / ₈	1, 2, MR2, 3, 4 or 5	27	13
LR2521	LRQ2521	25	21 ¹ / ₄	21	15 ³ / ₄	8	24 ³ / ₈	20 ⁵ / ₈	1, 2, MR2, 3, 4 or 5	30	15
LR3122	LRQ3122	31	22	28	16	7 ⁵ / ₈	30 ³ / ₈	21 ³ / ₈	1, 2, MR2, 3, 4 or 5	36	19
LRS3322	LRSQ3322	33	22	28	16	7 ⁵ / ₈	32 ³ / ₈	21 ³ / ₈	1, 2, MR2, 3, 4 or 5	36	19 ¹ / ₂

*Length is left to right. Width is front to back.

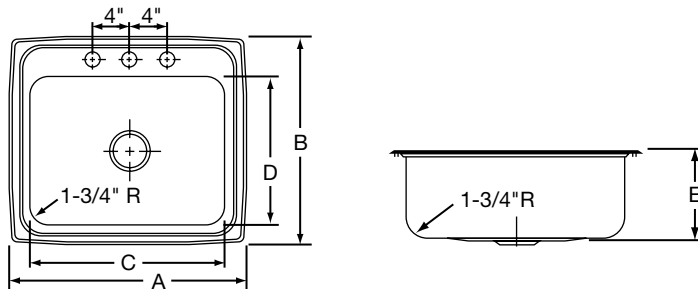

ALL DIMENSIONS IN INCHES, TO CONVERT TO MILLIMETERS MULTIPLY BY 25.4.

In keeping with our policy of continuing product improvement, Elkay reserves the right to change product specifications without notice.

This specification describes an Elkay product with design, quality and functional benefits to the user. When making a comparison of other producers' offerings, be certain these features are not overlooked.

**HOLE DRILLING
CONFIGURATIONS**

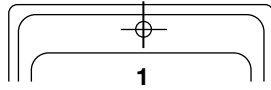

1

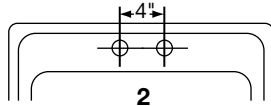

2



MR2



3



4



OS4

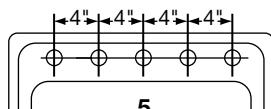

5

Quick-Clip® Mounting System

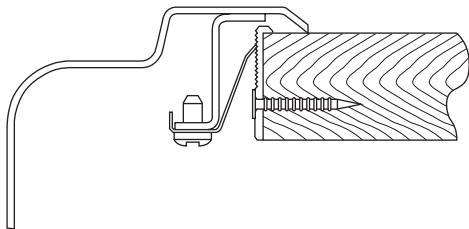

U-Channel Type Mounting System

