



COMMERCIAL PLASTIC SEATS

MODEL 9500C

Seats shall be No. _____ as manufactured by Church Seats. Seats shall be extra heavy weight and injection molded of solid plastic. Seats shall be open front less cover for elongated bowl and feature large molded-in bumpers. External check hinges to feature 300 Series stainless steel posts that stop seat 11 degrees beyond vertical. Uses 300 Series stainless steel hardware. Color to be _____ (specify white or fixture manufacturer's color.) Hinges shall be _____.

- ELONGATED SEAT
OPEN FRONT LESS COVER
- SOLID PLASTIC
- EXTERNAL CHECK STAINLESS
STEEL HINGES

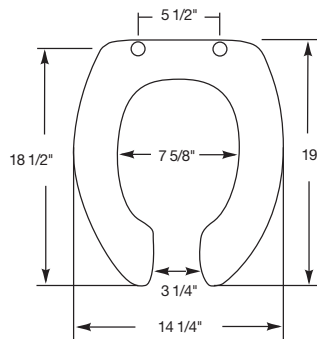

- 9500C Open front seat less cover/external check hinge stops seat 11° beyond vertical.
- 9500SSC Open front seat less cover/stainless steel, self-sustaining and external check hinge holds seat in any raised position up to 11° beyond vertical.

Ring thickness is 1"
Ring thickness including the bumper is 1-3/16"



** ANSI Z124.5 section 5.1.2 Tests have shown that this product will support weights up to 500 pounds. ** (Contact Church Seat Co., for test data)